



CFT Series

CABINET FAN



Cabinet Fan - CFT Series



- Cabinet is manufactured in galvanized sheet steel incorporated with a belt driven, high efficiency, double inlet forward curve, backward curve or airfoil wheel.
- Complete with inlet & outlet flange as standard.
- Motor and drive assembly can be accessed through removal of two side panels.
- Internal vibration isolator to assure long life and quiet operation.
- Penta Post construction with ABS plastic corner piece, aluminum column and reinforced galvanized sheet panel
- Acoustic lining is available upon request.
- Standard acoustic lining employs galvanized sheet facing
Perforated sheet facing is available upon request.
- Type of fan use: CFT 200 to CFT 710 ---- FDA/BDB/ADA 'C' type
CFT 800 to CFT 1000 ---- FDA/BDB/ADA 'T' type



Kruger Ventilation Industries Pte Ltd certifies that the **CFT series** shown herein is licensed to bear the AMCA Seal. The ratings shown are based on tests and procedures performed in accordance with AMCA publication 211 and comply with the requirements of the AMCA Certified Ratings Program. Models CFT 200~280 are not licensed by AMCA International.

Dimension

90° Orientation

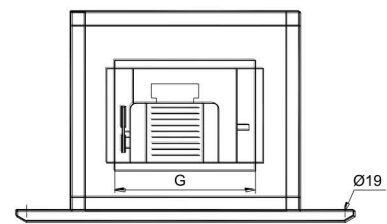
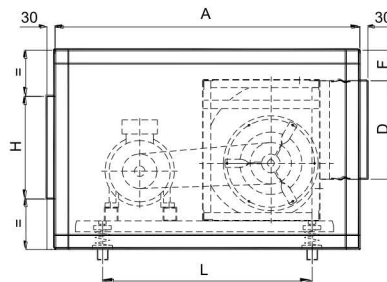
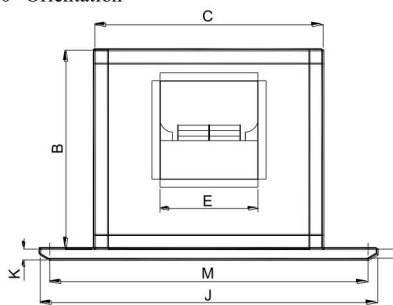

360° Orientation

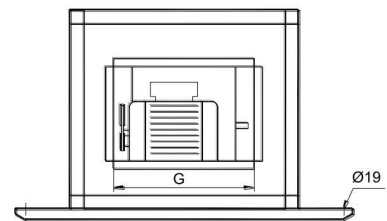
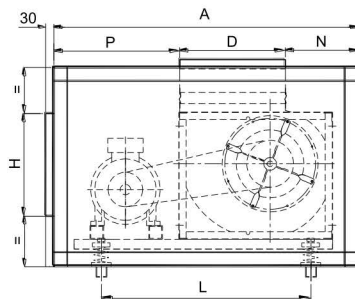
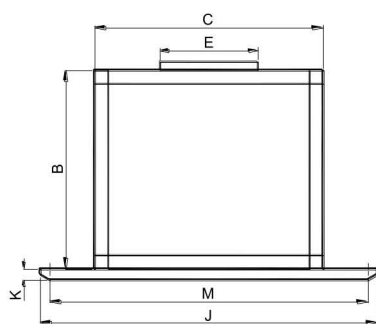

All Dimension in mm.

Model	A	B	C	D	E	F	G	H	J	K	L	M	N	P	Weight* (kg)	Max. Motor* Frame Size
CFT200	880	589	662	256	256	106	472	399	962	40	580	862	190	434	49	100L
CFT225	960	635	734	288	288	106	544	445	1034	40	660	934	204	468	55	112M
CFT250	1000	679	810	322	322	106	620	489	1210	40	700	1110	214	464	61	112M
CFT280	1120	736	900	360	360	106	710	546	1300	40	770	1200	232	528	67	132S
CFT315	1200	798	1000	404	404	106	810	608	1400	40	850	1300	261	535	81	132M
CFT355	1300	871	1109	452	452	106	919	681	1509	40	950	1409	286	562	93	132M
CFT400	1400	954	1234	506	506	106	1044	764	1634	40	1050	1534	315	579	110	160M
CFT450	1500	1055	1371	568	568	106	1181	865	1771	40	1100	1671	344	588	129	160M
CFT500	1600	1175	1568	638	638	123	1348	955	1968	50	1200	1868	365	597	146	160L
CFT560	1700	1285	1742	714	714	123	1522	1065	2142	50	1300	2042	399	587	154	160L
CFT630	1900	1410	1940	800	800	123	1720	1190	2340	50	1350	2240	441	659	187	180M
CFT710	2100	1584	2164	898	898	123	1944	1364	2664	100	1400	2564	487	715	249	180L
CFT800	2300	1750	2413	1006	1006	123	2193	1530	2913	100	1600	2813	545	749	290	200L
CFT900	2530	1930	2681	1130	1130	123	2461	1710	3181	125	1830	3081	601	799	335	225S
CFT1000	2700	2090	3000	1266	1266	123	2780	1870	3500	150	1900	3400	625	809	389	225M

* Weight without fan, motor and drive transmission.

* Please consult KRUGER for details when motor frame size is beyond this range,